

REINFORCED BOX GUTTER INSTALLATION

(USE IN CONJUNCTION WITH STANDARD GUTTER INSTALLATION STEPS)

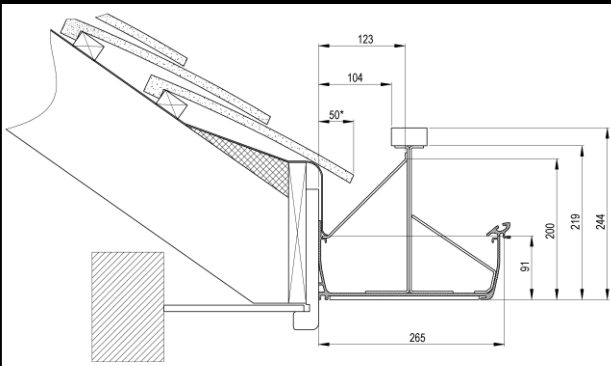

PRE-CHECKS / ADVICE

Box gutter weight is approximately 13kg/m. A 6m box gutter will weigh approximately 78kg. You may consider using lift equipment such as a genie lift or similar.

If fixing to a bungalow soffit, we recommend checking behind the fascia to ensure that there is a suitable substrate to fix to.

Check the roof tile overhang (minimum of 50mm) to ensure it will not foul on the gutter reinforcement. If so either pack off (affecting the roof size) or reduce tile overhang.

SUPPORTS

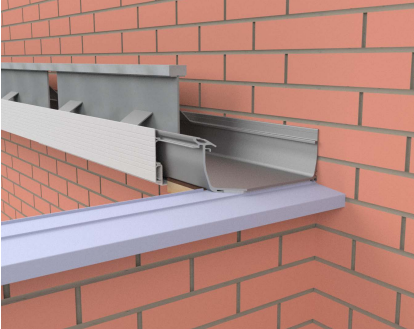

When using the reinforced box gutter, it MUST be supported at each end by either hup walling, a brick pier, or a post (by 100mm minimum). When the overall length is greater than 6m and a split is required, the box gutter **MUST** be supported by at least 100mm either side of the joint.

If you would like to use a post as a support, please contact Ultraframe.



1

Lift the box gutter into position, taking into consideration the weight.

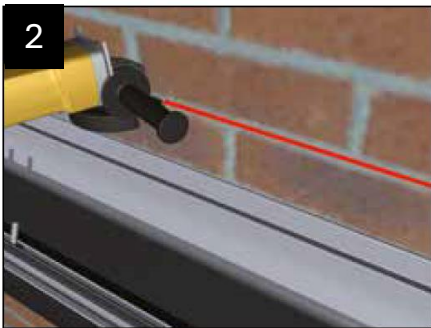

2

Whilst still supported, pull gutter away from the wall for access and grind a channel in the masonry for flashing. Blow out any dust in the channel.

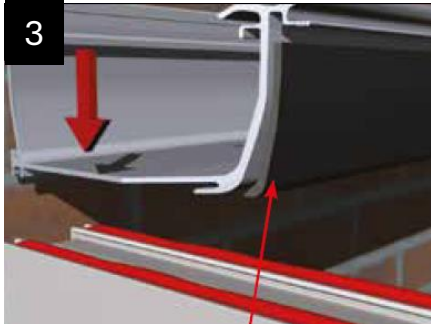

3

Lift gutter slightly to cut back foam insulation to enable the box gutter to sit flush on the supports. Apply a continuous bead of appropriate sealant to the front and inner of the supports. Lower the insulated box gutter into position – ensure it has adequate support whilst fitting.



4

If required, place eaves beam section – with under gutter trim attached onto the side frames. Seal the joint between the eaves beam and box gutter.



5

Ensuring the box gutter is level, fix back into the host wall through each gap in the I-beam and at both ends of the gutter using appropriate anchor fixings for the substrate. Dependant on access, a socket wrench may be used to reach behind the reinforcement.

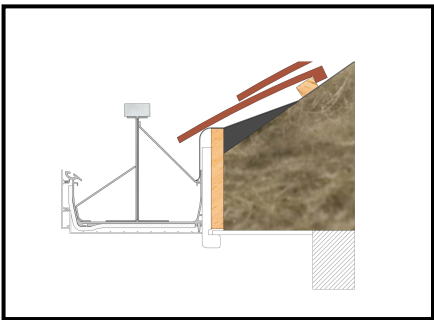

If fitting to a bungalow soffit, ensure that box gutter is fixed along its length into a suitable timber batten behind fascia board using appropriate fixings. When installing a box gutter on a soffit, ensure the soffit is insulated to avoid condensation